



TheRunLock

Operating & Resetting Instructions

Copyright © 2016 DRAB Enterprises LLC
www.TheRunLock.com

How To Operate TheRunLock

HOW TO OPEN:

- 1** Rotate dials until your specific code is aligned with the red bars.



- 2** Pull shackle (A) up and open the key compartment door at the red arrow.

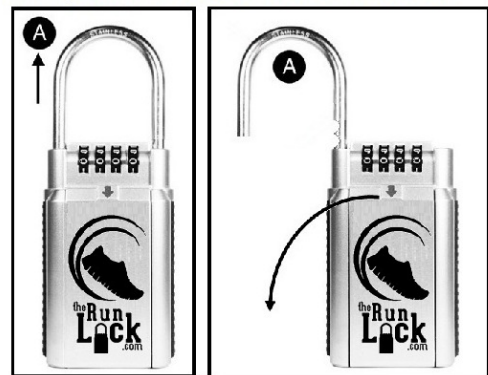

HOW TO CLOSE:

- 1** With dials rotated to your specific code, close the key compartment door. Close shackle (A) by pressing down until it latches.



- 2** Rotate dials to a different code and tug on the shackle (A) to confirm the lock remains locked.

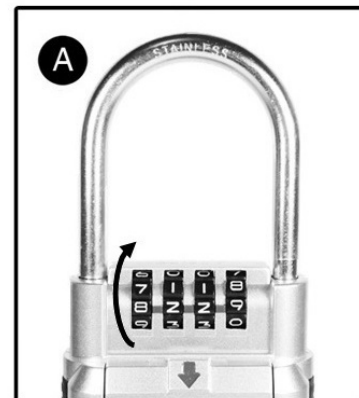

*Instructions to Reset TheRunLock's 4 Digit Combination Code
Are shown on the backside of this page.*

How To Reset TheRunLock's 4 Digit Combination Code

*The following reset instructions MUST be read thoroughly and followed with extreme care.
An incorrect reset will render the lock permanently inoperative.*

Your reset pint tool (E) is packaged inside of the key compartment. To retrieve, reference "How To Open" instructions.

- 1 TheRunLock combination is preset to 0-0-0-0. With the lock empty and key door closed, rotate dials to 0-0-0-0 and pull the shackle (A) upward until half of the second cut-out (B) becomes visible.

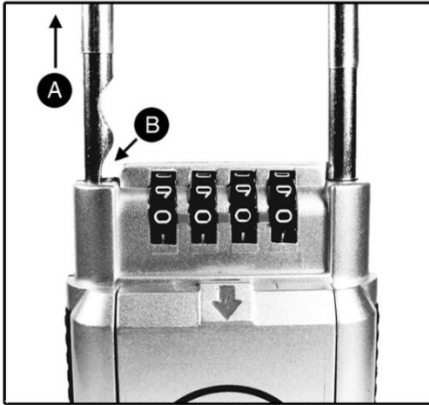

DO NOT lift the shackle completely out of the lock. The right end of the shackle (reset hole side) must be inside of the lock; below the top of the lock (C) and above reset hole (D).

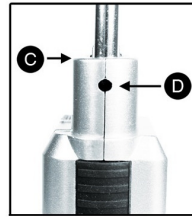

Aligning the end of the shackle between (C) and (D) is called the "Correct Reset Position."

CORRECT RESET POSITION:

Half of second cut-out (B) is visible and right end of shackle (A) is below the top of lock (C) and above reset hole (D).

- 2 With the combination still set at 0-0-0-0 and the shackle in the "Correct Reset Position," insert the reset pin tool (E) into the reset hole (D). While holding the lock in your right hand, firmly press and hold the flat surface of reset pin tool (E) with your right thumb – this will depress the spring loaded reset button inside the reset hole (D).

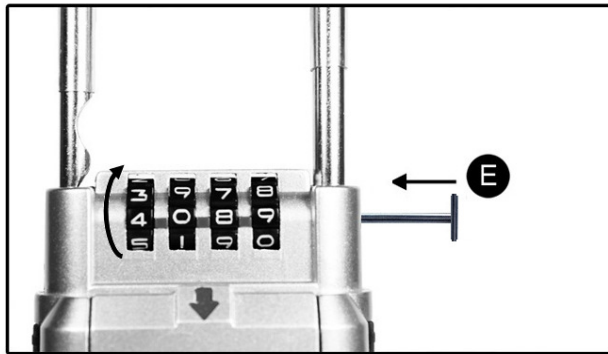

WRONG RESET POSITION:

Cut-out (B) is fully visible and shackle (A) comes out of the top of the lock (C).

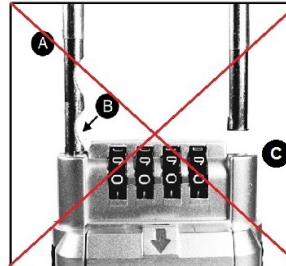

WRONG RESET POSITION:

Shackle (A) is fully open and turned outward.

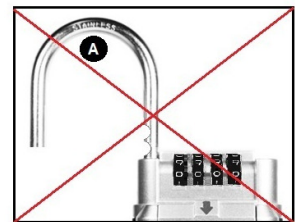

Keeping the reset button firmly depressed, rotate the dials to your new combination.

DO NOT rotate a dial while the reset button is not fully depressed – this will render the lock inoperative.

- 3 Once you have rotated the dials to your new combination, release the reset tool (E) with your right thumb and remove the reset tool (E) from the reset hole (D). Press the shackle (A) down to complete the combination code reset process.

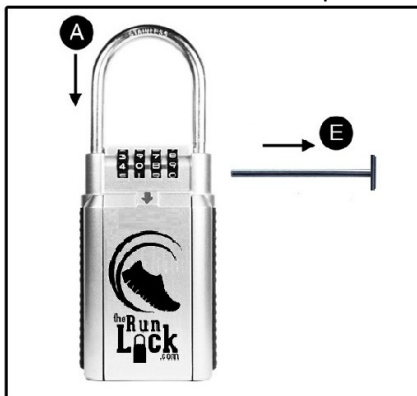

Rotate dials to a different code and tug on the shackle (A) to confirm the lock remains locked.

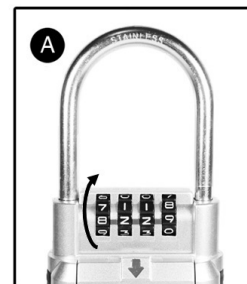

For More Information, Visit www.TheRunLock.com